

SnapGRID® STONE

Installation Instructions

UPON DELIVERY OF PRODUCT

1. **VERIFY** packing slip correctly matches with product and order quantities.
2. **INSPECT** the delivered product thoroughly. Report any discrepancies of original order, product defects, damages, etc. within 24 hours. Perfect Surfaces will not provide reimbursement or warranty claims for labour on material installed with visual defects. Any defects (size, colour, or otherwise) must be reported by the customer to the place of purchase prior to installation.
3. **STORE** product in a clean, dry environment **with temperatures between 59 -79°F (15-26°C)**.
4. **READ** product and sub-floor preparation, instructions, warranty, and other disclaimers carefully and completely before beginning any installations.
5. **REVIEW** these important steps prior to installation:
 - a) Acclimatize tiles for a **minimum of 48hrs before installation at an ambient temperature of 65 - 79°F (18-26°C)**. Temperature should remain constant during install and 24 hours after installation to avoid thermal dimensional change in individual flooring components.
 - b) If the tiles will be exposed to direct sunlight, or directly near/under a heat source they should be fixed in place with tape or adhesive.
 - c)

⚠ WARNING:

DO NOT use SnapGRID® STONE tiles in conjunction with any petroleum-based products. This includes solvents, adhesives, or sealants. All substrates (especially new concrete) must be fully cured for 45 to 60 days prior to installing SnapGRID® STONE tiles.

INTRODUCTORY NOTE: This installation guide is intended to provide the necessary information for the proper installation of Perfect Surfaces SnapGRID® STONE tiles. These instructions are based on industry standards and are provided for informational use only.

PERFECT SURFACES INC. DOES NOT WARRANTY ANY INSTALLATION PERFORMED PURSUANT TO THESE INSTRUCTIONS OR OTHERWISE AND SPECIFICALLY DISCLAIMS LIABILITY FOR ANY DIRECT OR INDIRECT PERSONAL INJURY, PROPERTY DAMAGE OR OTHER COSTS OR LOSSES RESULTING FROM INSTALLATION.

RECOMMENDED TOOLS

The following items will be necessary for a complete installation of your flooring system. Some items are optional or may be substituted for similar tools. References made in this manual will be for the tools outlined below:

- 30' and 100' Tape Measure
- Utility Razor Knife w/Replacement Blades
- Permanent Markers and/or Marking Crayons
- Knee Pads
- Non-Marking Athletic Shoes
- Jigsaw or Tabletop Band Saw
- 4' Level or Pole
- Safety Glasses
- Chalk Line
- Rubber Mallet (*White for light tiles, Black for dark tiles*)
- Heat gun



888.363.6289



sales@perfectsurfaces.ca



www.perfectsurfaces.ca



833.775.8838



sales@perfectsurfaces.com



www.perfectsurfaces.com

General Information

Floor tiles should always be installed on a hard and level surface. As detailed below, the tiles should also be acclimatized for 48 hours before starting your floor. Floors expecting heavier loads should be glued or taped securely in place. Ensure a careful measurement of the room by laying all tiles out and leaving the same amount of extra space on all sides of the room. Allow a gap of 3/8" (10mm) from any fixed point. Check the precision of laying individually installed rows against the lines marked out and their right angles. This is especially true for larger areas and rooms that are not sufficiently rectangular.

Sub-Floor & Job Site Conditions

Tiles should not be installed until all other trades are finished in and around the area where the tile is to be installed. Per the product specifications, the subsurface should have a level tolerance of +/- 1/8" (3mm) in any 10' (3m) radius. Any variation from this should be addressed prior to the installation of the floor. SnapGRID® STONE tiles can be installed on virtually any smooth and even hard surface. Fill in any unevenness or holes with grout or a sealant designed for repairing floors. To ensure permanent function and quality of the PVC flooring, the structure or surface should be flawless.

Installation Guidelines

To reduce material costs and installation time, it is necessary to understand the products and necessary installation equipment and tools. Outlined in this installation manual you will find the tips and tricks to ensure a first-class installation. If there is still construction work in progress, protect any newly laid floor tiles with a suitable protective cover. Limit the risk of inadvertent damage.

Acclimatization

Do not install the floor tiles immediately after their delivery; allow the flooring to acclimatize for at least 48 hours prior to installation. The acclimatization shall take place at air temperature of 65-79°F (18-26°C). The higher the temperature, the faster the floor tiles acclimatize. The tiles must be unloaded from pallets and spread in the room where they are expected to be installed. To facilitate the acclimatization process, spread the floor tiles in smaller units, e.g. in bundles of six pieces. Note that the temperature of the subfloor must not fall below 59°F (15 °C). Working temperature during the installation and 24 hours after the installation must be constant, in the range from 65-79°F (18-26°C), to avoid any thermally conditioned dimensional changes of individual flooring components. When installing at normal temperature deviations, note the movement of the floor and leave a gap of at least 3/8" (10mm) between the floor tiles and any fixed points (e.g. a wall).

NOTE: If the installation takes place at a temperature below 59°F (15°C), leave a larger expansion gap (joint) between the floor tiles and any fixed points (e.g. a wall).

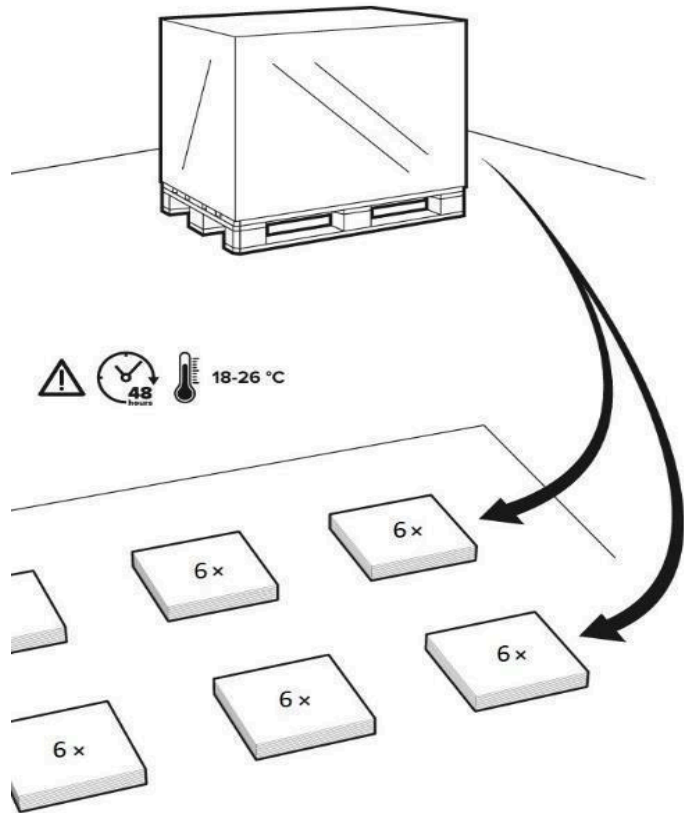

888.363.6289



sales@perfectsurfaces.ca



www.perfectsurfaces.ca



833.775.8838



sales@perfectsurfaces.com



www.perfectsurfaces.com

Installing SnapGRID® STONE tiles

To begin installation, you will need to locate the entrance of the room or facility and make a mark in the center of the floor with chalk or a laser. From there draw two perpendicular lines one after the other, see the dashed lines in diagram. Lay out the tiles along these lines in order shown in the picture, **rotating each tile 90° from the tile installed previously**. In most instances it is required to center the floor entry to your garage, workshop, commercial facility, or special event. If you want ramps positioned precisely at the entrance, put two rows of floor tiles along the line and connect the ramps and corners where required. Any final cuts or modifications to the floor tiles on the outer edges or near fixed objects should be done only after all the tiles have been laid. When cutting the floor tiles on the outer edges, **maintain the gap of at least 3/8" (10 mm) from any fixed point**; this gap can be covered with baseboards.

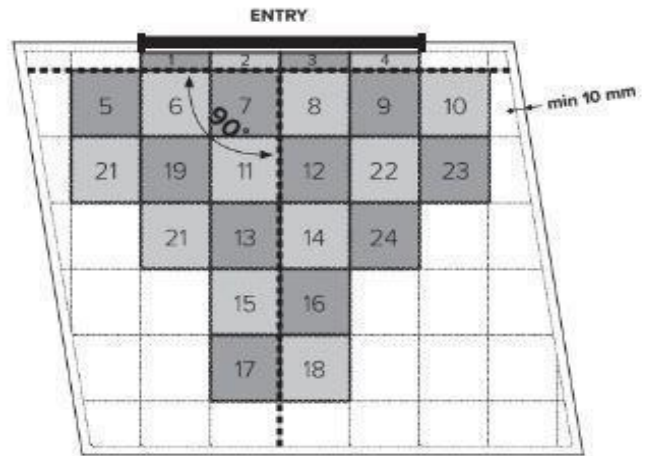

Cutting SnapGRID® STONE tiles

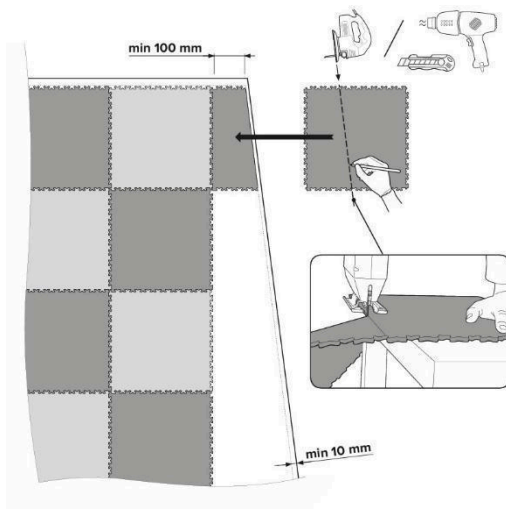

When cutting the tile, the cut side must be measured against the wall or a fixed point to ensure the recommended expansion gap is maintained after laying the tile in place. Maintain this expansion for all intruding or adjoining structures (e.g. heating, other types of floor coverings). The gaps can be covered up with baseboards at the end. For quick and easy straight cuts, a cutter/guillotine is recommended. A folding knife or a straight saw can be used for rounded cuts. Templating is recommended prior to making difficult and complicated cuts. Hot air guns can be used to heat up the tile at the cutting point to allow for easier incision and are recommended when making more difficult cuts (e.g. around heaters, door frames, niches and external corners). It is important to note that when heating the tiles to cut them, the tiles should **only be heated from the underside**.

NOTE: A width of more than 1/3 of the tile dimension is recommended for cut tiles placed closest to the walls. At doors and recesses, the surface of the cut floor tile must be bigger than a half of the whole original tile.

Adhering SnapGRID® STONE tiles

While not typically necessary, SnapGRID® STONE tiles may require adhesion in select applications. Some forklift trucks and pallet trucks can impair the durability of the interlocks of SnapGRID® STONE PVC flooring; these include heavy trucks with small wheels, especially heavy-duty electric trucks where the battery is placed over the main drive axle. Testing SnapGRID® STONE floor tiles with these vehicles and/or equipment before full installation is recommended. If determined sufficient, ensure the tiles are fully adhered to the substrate with GatorTAPE® or Tru GLU if exposure to these vehicles and/or equipment is expected. Additionally, recycled floor tiles are more expansive than floor tiles made of initial raw materials. Due to their thickness, SnapGRID® STONE tiles can be more expansive and therefore, they need to be glued in places where the tiles may heat up, including (but not limited to) glazed parts of the room, loading areas with doors facing south, ceiling skylights, etc. Floor tiles exposed to direct sunlight can easily heat up and expand faster and in greater value than the rest of the floor. Ovens, furnaces, catalytic converters, and other heat sources can heat up the floor, causing the floor tiles to expand. To keep this from happening, glue the floor tiles around the heat source.

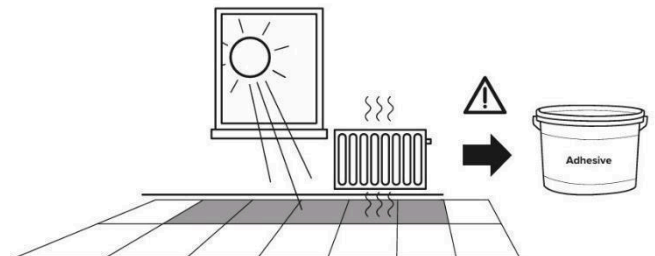

888.363.6289



sales@perfectsurfaces.ca



www.perfectsurfaces.ca



833.775.8838



sales@perfectsurfaces.com



www.perfectsurfaces.com